



ES
TD

THE
BASICS

BACK-TO-SCHOOL GUIDE
2022-2023

CONTACTS

MAIN CAMPUS NUMBER
830-438-3211

PRINCIPAL | CHARLES ELERICK
CHARLES.ELERICK@BRACKENCHRISTIAN.COM

ELEMENTARY ASST. PRINCIPAL | JEN STREGE
JEN.STREGE@BRACKENCHRISTIAN.COM

STREAM DIRECTOR | JAMIE KING
JAMIE.KING@BRACKENCHRISTIAN.COM

ELEMENTARY ADMIN OFFICE | HEATHER RUTHERFORD
HEATHER.RUTHERFORD@BRACKENCHRISTIAN.COM

SECONDARY ADMIN OFFICE | ATHENA MARSHALL
ATHENA.MARSHALL@BRACKENCHRISTIAN.COM

ATHLETIC DIRECTOR | TERRI SANDERS
TERRI.SANDERS@BRACKENCHRISTIAN.COM

CLINIC | LYNDA VARELA
LYNDA.VARELA@BRACKENCHRISTIAN.COM

LIBRARY | TERI JENNINGS
TERI.JENNINGS@BRACKENCHRISTIAN.COM

ADMISSIONS | MALLORY SMITH
MALLORY.SMITH@BRACKENCHRISTIAN.COM

TUITION | CATHY VIA-REQUE
CATHY.VIA-REQUE@BRACKENCHRISTIAN.COM

DONATIONS | VERLYN MALDONADO
VERLYN.MALDONADO@BRACKENCHRISTIAN.COM

SOCIAL MEDIA

GOD IS WRITING A BEAUTIFUL STORY ABOUT BRACKEN, SO LET'S TELL IT TOGETHER.

VISIT OUR WEBSITE OFTEN TO HEAR THE AUTHENTIC VOICES OF OUR FAVORITE STORYTELLERS ON CAMPUS, OUR TEACHERS!

TO FOLLOW US ON SOCIAL MEDIA FOR ANNOUNCEMENTS, REMINDERS, AND CAMPUS NEWS, BE SURE TO CHECK...

**SOCIAL MEDIA HANDLE
ACROSS ALL PLATFORMS**

@BCS_WARRIORSTX

MARK YOUR CALENDAR

CAMPUS-WIDE FUN DAYS

September

6th-9th | Book Fair
9th | Grand Event (Grandparents Day)
22nd | Fall Sports Pep Rally "Let's Go-Let's Glow" wear NEON

October

24th-28th | Homecoming Spirit Week
28th | Homecoming Pep Rally "BCS Blue Out" wear ALL BLUE
28th | Homecoming Tailgate + Punt Pass + Game + After Party (honoring alumni)

November

15th | Pajama Day

December

14th | Christmas Program 7:00 pm
15th | Ugly Christmas Sweater Day

January

TBA | Winter Sports Pep Rally "Hunt the ____" wear CAMO

February

TBA | Spring Sports Pep Rally "Wild About the Warriors" wear ANIMAL PRINT

March

2nd | Dr. Seuss Day (SALT)

April

5th | Easter Program 7:00 pm
13th | Tropical Day

May

5th | Field Day

STREAM families: every effort has been made to schedule fun days on campus days. However, if a fun day falls on a home day, please defer to your classroom teachers for ways to celebrate at home or on another campus day!

CAMPUS MAP

**Bracken Christian School
2022-2023**

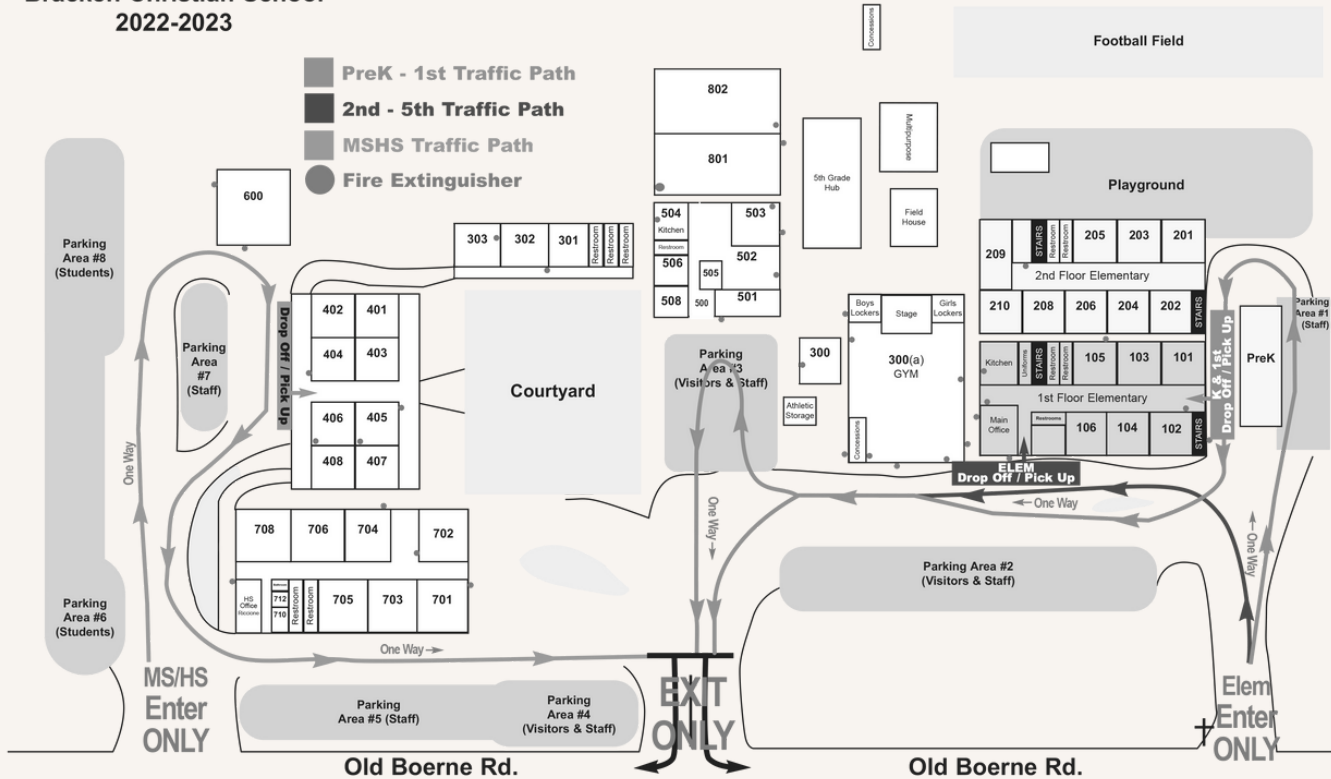

VISITING CAMPUS?

If you'd like to visit campus during school hours, please make sure you check in to our main office first. You'll need to sign in, get a visitor's pass, and sign out before leaving campus. In order to keep our students as safe as possible, we are committed to the ongoing acquisition of security personnel, technology, and physical structures.

PICK UP/DROP OFF INFO

Pre-k through 5th grade families can enter through the elementary gate for pick up and drop off. Pre-k through 1st grade will round the portables toward the covered awning for pick up assistance. Please have your pick up card readily available to make this process as smooth and efficient as possible. We ask that parents stay in vehicles for the safety and efficiency of carline pick up/drop off.

PLEASE DO NOT DROP STUDENTS OFF PRIOR TO 7:30AM

PARENTS WEB

FACTS SIS School Management Software gives you, the busy parent, an opportunity to get more involved in your child's academic progress and future success – all via the Internet!

FACTS SIS- ParentsWeb is a private and secure parents' portal that will allow parents to view academic information specific to their children, while protecting their children's information from others. You can see your child's grades, attendance, homework and conduct, as well as other useful school information. You can also communicate with teachers and other school staff online whenever necessary. All you need is an Internet-capable computer or phone. Here's how to access our easy-to-use

FACTS SIS- ParentsWeb:

- Go to your web browser and enter in **www.brackenchristian.com**.
- Click **BCS Families** button on top left corner of your screen
- Log in as follows:
 - 1.Type **"BRAC-TX"** for your District Code
 - 2.Enter Username: (new families you would have created this in your application process)
 - 3.Enter Password
 - 4.Select **Parent** option (or **student** if he/she is logging in)
 - 5.Click **Login** button.

You should now be logged in to the School Information home page of *FACTS SIS*

Once you have logged in to your FACTS SIS online, download the **"RenWeb Home App"** on your smart phone.

You have instant access anywhere to your student's homework, grades, lunches and your financial account.

Please call the school office at 830-438-3211 if you have any problems or questions. Some of you may not have your current email address in our system or it may need to be re-entered for you, either way we are happy to assist you.

We look forward to your participation. Together we can continue to improve our children's academic development as well as communication between our school and your home.

BCS LUNCH PROGRAM

HOW do we order?

Orders must be placed by 8:00PM the evening prior.

1. Go to www.brackenchristian.com
2. Click on ParentsWeb and Log In
3. Click on Student Information and scroll down to the bottom of the screen
4. Click on Lunch Calendar and Order and scroll down to the bottom of the screen
5. Click on Create Web Order
6. All students for your account will be on this screen
7. Find the date and item you want to order
8. Click on Quantity and type the number
9. Repeat #7 and #8 as needed (you can order for the whole year if you want!)
10. After you have completed your order, scroll down to the very bottom
11. Click on Order Items and WAIT for the screen to say "Web Order Created..."

Download the FACTS App for easy ordering.

You will be responsible for all lunch charges.

If your child is absent on a day that you ordered lunch, you will be responsible for cancelling the lunch order.

HOW do we pay?

Your Bracken Account will be charged AFTER your student has eaten lunch and charges may be paid monthly and will appear on your family account.

LUNCH MENU

MONDAY - MARCO'S PIZZA

TUESDAY - CHICK-FIL-A

WEDNESDAY - OLD WEST BURGERS

THURSDAY - PANDA EXPRESS

FRIDAY - JIMMY JOHN'S

PARENTS CONNECT

Helping Hands

We love it when our parents join in on the fun! The best way to get plugged in as a parent is to connect with Helping Hands. This group was created by Bracken parents to uphold the school in prayer, foster community, and serve our school family for the glory of God.

If you'd like to be a part of serving on campus (in big ways or small), please reach out! helpinghands@brackenchristian.com

Bracken Backers | Athletic Booster Club

We love it when our parents team up with our coaches and athletes! Level up your school spirit by getting connected with our athletic booster club. The Bracken Backers are a benevolent, Christ-led group of parents whose purpose is to serve the Bracken athletic community and its fans. The Backers are a beacon of Jesus' example of service and support through organizing and hosting special events, providing funding for athletic needs, and more importantly, supporting our young men and women in their pursuit of Jesus and being a light through serving and leading those around them. Email bracken.backers@brackenchristian.com to get more information.

Bracken Business Network

We have a big heart for supporting local businesses in our community. As part of our Bracken family, we invite you to participate in our Bracken Business Network. Our goal is to be able to help find more businesses and jobs for families that are tied to Bracken. If you own or operate a business nearby and would like to be added to this network, please visit our website and submit the online form. You can find this form [here](#).

STUDENT GMAIL ADDRESS

Bracken Christian School takes advantage of the Google Education Suite. All Bracken students are given a Bracken email address. Student emails use the following naming convention:

fflast@brackenchristian.com

First two letters of the student's first name then student's last name.

For example, Bob Jones would be bojones@brackenchristian.com.

Passwords are set temporarily to Bracken123. At the first login, the system will ask for the password to be changed.

Do not setup two-step verification as this can create problems for other Google apps.

Any forgotten passwords can be reset by contacting the IT Director at: bcstech@brackenchristian.com.

All Google Suite applications (Docs, Sheets, Slides and Classroom) are based on the student's Bracken gmail account.

Google Classroom | Bracken uses system integration between its Student Information System (SIS) and Google Classroom. Students are enrolled in the classroom based on their Bracken gmail account. Some teachers use Google Classroom throughout the year while others use it just when students are out of the classroom. Google Classroom provides a solution for students to see their upcoming assignments and due dates and provide an organized means of submitting their assignments when off campus.

NOTE: Bracken gmail accounts are used only for academic purposes. Only enrolled students have access to their accounts. Once a student withdraws or graduates from Bracken, their Bracken gmail account is deleted.

DAILY UNIFORMS

ELEMENTARY STUDENTS

Regular Uniform Dress – Girls Pre-K3 – 2nd

- Navy Peter Pan Knit Dress - purchased from The Speckled Goats; length must be no more than 2 inches above the knee; navy modesty shorts required under dress but should not be visible below the hemline; navy leggings allowed in cold weather
- Khaki or Navy Uniform Pants or Uniform Shorts - purchased from any uniform retailer; straight front; not excessively tight; shorts length no more than 3 inches above knee; belt required for 2nd grade
- Solid black or brown belt - standard buckle; no additional color or ornamentation; to be worn with pants or shorts for 2nd grade
- Navy, White, or Grey knit polo with school logo - purchased from The Speckled Goats
- Athletic Shoes - navy, white, grey, brown, black, or any combination of these colors ONLY
- Solid navy, white, or grey socks - no other colors or ornamentation
- Hair accessories may be navy, white, grey, or Bracken plaid; simple and small in style; must compliment the uniform; no feathers, jewels, animal ears, or other decorative pieces

Regular Uniform Dress – Girls 3rd – 5th

- Plaid skirt - purchased from The Speckled Goats; length must be no more than 2 inches above the knee; modesty shorts required under skirt but should not be visible below the hemline; navy leggings allowed in cold weather
 - Khaki or Navy Uniform Pants or Uniform Shorts - purchased from any uniform retailer; straight front; not excessively tight; shorts length no more than 3 inches above knee; belt required
 - Solid black or brown belt - standard buckle; no additional color or ornamentation
 - Navy, White, or Grey knit polo with school logo - purchased from The Speckled Goats
 - Athletic Shoes - navy, white, grey, brown, black, or any combination of these colors ONLY
 - Solid navy, white, or grey socks - no other colors or ornamentation
 - Hair accessories may be navy, white, grey, or Bracken plaid; simple and small in style; must compliment the uniform; no feathers, jewels, animal ears, or other decorative pieces
-

DAILY UNIFORMS

ELEMENTARY STUDENTS CONT'D

Regular Uniform Dress – Boys Pre-K3 – 5th

- Khaki or Navy Uniform Pants or Uniform Shorts - purchased from any uniform retailer; straight front; not excessively tight; shorts length no more than 3 inches above knee; belt required
- Solid black or brown belt - standard buckle; no additional color or ornamentation
- Navy, White, or Grey knit polo with school logo - purchased from The Speckled Goats
- Athletic Shoes - navy, white, grey, brown, black, or any combination of these colors ONLY
- Solid navy, white, or grey socks - no other colors or ornamentation

Outerwear - Boys & Girls (All Grades)

- All outerwear worn inside the building must be purchased from the campus spirit shop
- Outerwear worn outside at recess may be any heavy jacket, hat, gloves, etc. Style and design must be appropriate in a Christian school setting
- Hats are not to be worn in the building

Spirit Dress - Boys & Girls (All Grades)

- Bracken-issued or spirit shop purchased shirts.
 - Jeans:
 - Must be blue denim; any stitched or attached designs must be limited to pocket areas only.
 - No holes, rips, tears, or large frays
 - Must fit modestly and appropriately in length, size, and rise on the waist
 - Bracken uniform shorts may be worn with a Bracken shirt.
 - Any color athletic shoes may be worn. NO BOOTS OR DRESS SHOES.
 - Any color sock is allowed as long as it is appropriate in a Christian school setting
 - Belts are not required unless deemed necessary to hold up pants.
-

DAILY UNIFORMS

SECONDARY STUDENTS

Regular Uniform Dress – Girls 6th - 12th

- Plaid skirt - purchased from The Speckled Goats; length must be no more than 2 inches above the knee; modesty shorts may be worn under skirt but should not be visible below the hemline; navy leggings allowed in cold weather
- Khaki or Navy Uniform Pants or Uniform Shorts - purchased from any uniform retailer; straight front; not excessively tight; shorts length no more than 3 inches above knee; belt required
- Navy, White, or Grey knit polo with school logo - purchased from The Speckled Goats
- *Solid black or brown belt* - standard buckle; no additional color or ornamentation
- Shoes - navy, white, grey, brown, black, or any combination of these colors ONLY; no boots; no open toe/heel
- Solid navy, white, or grey socks - no other colors or ornamentation
- Hair accessories may be navy, white, grey, or Bracken plaid; simple and small in style; must compliment the uniform; no feathers, jewels, animal ears, or other decorative pieces

Regular Uniform Dress – Boys 6th -12th

- Khaki or Navy Uniform Pants or Uniform Shorts - purchased from any uniform retailer; straight front; not excessively tight; shorts length no more than 3 inches above knee; belt required
- *Solid black or brown belt* - standard buckle; no additional color or ornamentation
- Navy, White, or Grey knit polo with school logo - purchased from The Speckled Goats
- Shoes - navy, white, grey, brown, black, or any combination of these colors ONLY; no boots, no open toe/heel
- Solid navy, white, or grey socks - no other colors or ornamentation

Outerwear - Boys & Girls (All Grades)

- All outerwear worn inside the building must be purchased from the campus spirit store
- Hats are not to be worn in the building and only on cold weather days outside

Spirit Dress - Boys & Girls (All Grades)

- Bracken-issued or purchased shirts.
 - Jeans:
 - Must be blue denim; any stitched or attached designs must be limited to pocket areas only.
 - No holes, rips, tears, or large frays
 - Must fit modestly and appropriately in length, size, and rise on the waist
 - Bracken uniform shorts may be worn with a Bracken shirt.
 - Any color athletic shoes may be worn. NO BOOTS OR DRESS SHOES.
 - Any color sock is allowed as long as it is appropriate in a Christian school setting.
 - Belts are not required unless deemed necessary to hold up pants.
 - Any outerwear may be worn as long as it is appropriate in a Christian school setting.
-

DRESS CODE

SCHOOLWIDE

Clothing

- All shirts should be worn with only the very top button open and tucked in to the point the belt is clearly visible.
- A white undershirt may be worn under the uniform shirt.
- A uniform shirt must be worn under hoodies and sweatshirts on uniform dress days.
- Uniforms must be worn correctly at all times, including before school, after school, and off campus.
- Uniform clothing should be in good condition and free from rips, frays, and other signs of excessive wear.
- Uniforms and other approved Bracken items should be worn as purchased and not modified or altered in appearance. Alterations may be made for sizing purposes only.
- Pants and shorts, both uniform and non-uniform, should not allow underwear (or worse) to become visible by others at any point or under any situation (sitting, squatting, bending over, etc.) They should also not be inappropriately tight or short.
- Shirts, both uniform and non-uniform, must be modest and appropriate in fit, style, and neckline at any point or under any situation (raising arms, leaning over, etc.). Strapless, spaghetti strap, or other like tops are not allowed.

Hair

- Boys' hair needs to be well kept, not excessively bushy or shaggy; above the eyebrow, ear, and shirt collar.
- Both boys and girls need to keep their hair in a solid natural color and avoid "faddish" or attention drawing styles.
- Boys should be clean shaven and sideburns should not extend below the middle of the ear.

Accessories

- No extra items or accessories are allowed during school hours. Examples of these items are as follows:
 - Decorative gloves
 - Chains from wallets/keys attached to belt loops
 - Girls only may wear one traditional earring in each ear and only in the ear lobe.
 - Tattoos, face or body piercings, gauges, and spacers are not allowed.
 - Jewelry for both boys and girls should not be excessively large and should coordinate with the uniform in color.
 - Hair accessories may be navy, white, grey, or Bracken plaid; simple and small in style; must compliment the uniform; no feathers, jewels, animal ears, or other decorative pieces
-

HAVEN'T GOTTEN YOUR UNIFORM YET?

Right now, our uniform provider is doing a great job keeping us in the loop and up to speed on when the new pieces come in. Due to supply issues, we did know there would be a chance our uniforms would not make it to our campus in time for the first day of school. Not to worry.

Polos and elementary dresses are on track to be here in **August/September**. The new plaid skirt is arriving in **October**. If you know your child will be missing some uniform pieces due to this transition, here are some options your family can consider while we excitingly wait for the new look:

WHAT TO DO IN THE MEANTIME + UNIFORM REMINDERS:

- Elementary girls are more than welcome to continue to wear the jumper/collared button-up as long as their heart's desire.
- Boys and girls can wear any version of our Bracken embroidered polo with navy or khaki shorts or pants until our new polos arrive. Remember older versions of our logo for polos are acceptable to wear for one more year.
- New students who don't have any polos for the start of school are welcome to wear a solid white, gray, or navy polo with navy or khaki shorts or pants until new uniforms arrive.
- Girls (3rd grade or older) can wear the older version of the plaid skirt as long as the length of skirt is no shorter than 3" above the knee. Young ladies who come to school with skirts shorter than this will be asked to change into a longer skirt or swap out for uniform shorts.
- All uniform shorts are to be navy or khaki and can not be shorter than a 7" inseam.
- Any colored Bracken spirit shirt can be worn on Fridays with jeans (no holes, rips/tears). Clarification! Jeans are only to be worn on Fridays.
- Remember that shoes need to be neutral in color (white, black, navy, gray, brown or any combination of).
- Remember that hair accessories need to be school colors only.
- Outerwear must be Bracken approved outerwear from our on campus spirit shop (all new items will be available for purchase at Warrior Rollout - you're going to love what we have).

WILL I BE NOTIFIED WHEN UNIFORMS DO COME IN?

Absolutely. As soon as we get word from our new provider, we will shout it from the hilltop and let you know when and where you can pick up your order on campus.

If you have any other questions regarding uniforms, please do not hesitate to reach out to Mr. Elerick.

NURSE'S NOTE

We take the health and wellness of our students seriously here at BCS. Everyone has a role in keeping our students and campus healthy. Below are preventive measures and policies regarding illness.

- Please assess your student(s) at home each morning before school drop-off to determine if they are feeling well and healthy.
 - Please keep your student(s) home if they are not well and healthy. Please use good judgment and consideration for others in this decision.
 - Please notify the school if your student will be absent and let us know the reason your student will be out for the day.
 - COVID absences: BCS will follow isolation measures in line with CDC recommendations. At this time (August 2022), the CDC recommends five (5) days isolation if the student or a member in the household is sick or tests positive. According to the CDC, day one (1) begins on the first full day of symptoms.
 - BCS cleans two times weekly with Vital Oxide (recommended is once every fourteen days). The lunch area is cleaned daily and between lunch periods.
 - BCS is equipped with UV lights on all HVAC Systems to assist with disinfection.
 - Hand sanitizing stations are located around the campus & hand sanitizer is available in each classroom. Please encourage your student(s) to use them often.
 - Please send your student with their own water bottle each day (with attached straw, flip-top lid, & please no glass). Filtered water is available at each water bottle filling fountain located throughout the campus.
-